

2.0

GLEDOPTO AMBIENT TV BACKLIGHT KIT

USER INSTRUCTION

PRODUCT DESCRIPTION

The gledopto ambient tv backlight kit processes the HDMI signal to make the connected LED strip change color or brightness synchronously with the TV screen. The light strip can display different colors around the TV screen.



PRODUCT PARAMETER

MODEL NO.:	GL-SN-002K
HDMI:	2.0
SYNC BOX SIZE:	60x90x20MM
INPUT VOLTAGE:	DC 12V
OPERATING TEMPERATURE:	-20°C~60°C
SYNC BOX IP RATE:	IP20
LIGHT STRIP IP RATE:	IP65
STRIP LIGHT LENGTH:	2M

PACKING LIST

01



02

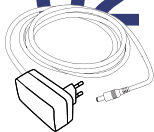

03



04



05



1 1M HDMI Cable × 1

2 12V Power supply × 1

3 HDMI SYNC Box × 1

4 12V 2m RGB strip × 2

5 User Instruction × 1

INSTALLATION DIAGRAM

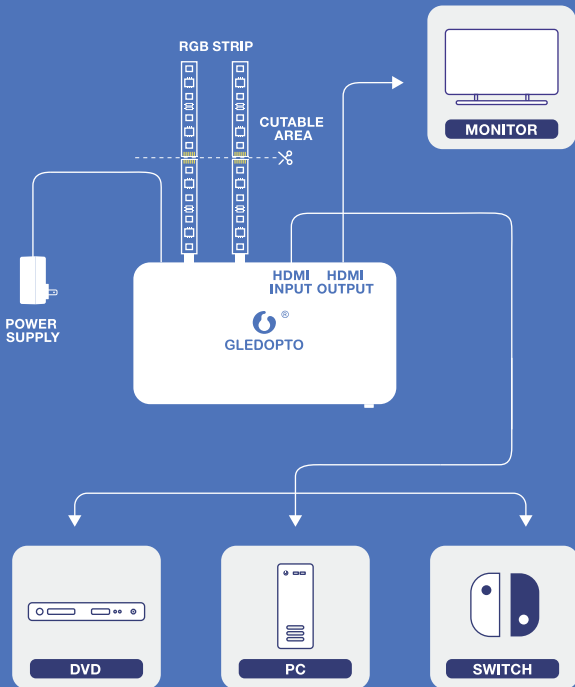

INSTALLATION FLOW CHART

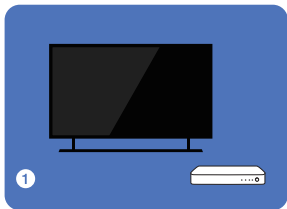

Place the sync box in the bottom right corner

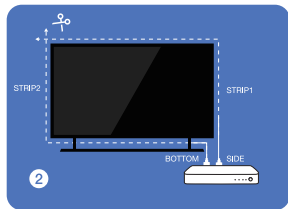

Wiring and cut off excess light strips

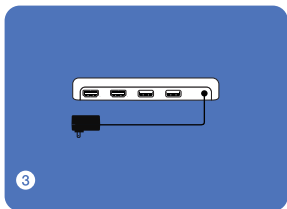

Connect to the power supply

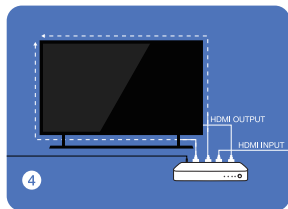

Now you can enjoy it

NOTICE:

1. The length of the light strip should not exceed the edge of the TV.
2. Need to cut off the excess light strips before powering on.

INSTALLATION DIAGRAM



Clean the back of the TV with a towel

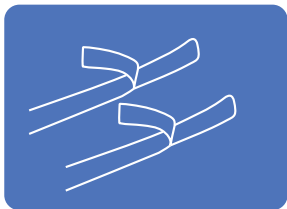

Tear off the double-sided adhesive tape

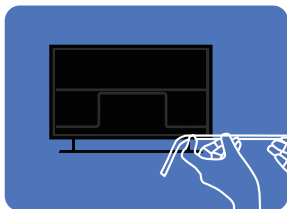

Stick the light strip on the back of the TV

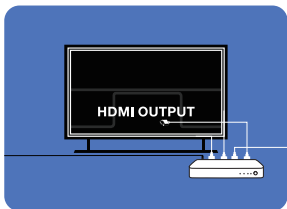

Now you can enjoy it



WARNING

BEFORE CUTTING THE LED STRIP, THE POWER OF STRIP LIGHT OR THE SYNC BOX MUST BE TURNED OFF.

FUNCTION DIAGRAM

FRONT

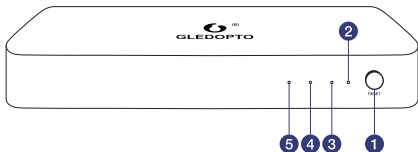

BEHIND

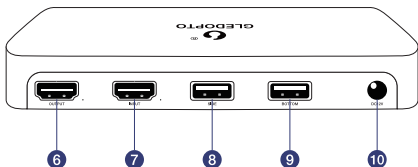

1 RESET BUTTON

Long press the “RESET” button until network indicator consistently flashes.

2 MICROPHONE

Receive external audio and realize the color change of the light strip.

3 WIFI SIGNAL LIGHT

When you press and hold the reset button to enter the "reset" mode, the light starts to flash and you can start the setting.

4 MODE LIGHT

Indicator color, default mode: red, sound mode: green, scene mode: blue.

5 POWER LIGHT

Bright white light when power on.

6 OUTPUT INTERFACE

Connect the output interface to the TV, projector or monitor screen with an HDMI cable.

7 INPUT INTERFACE

Connect the input interface to the Switch, and other games devices, computers, laptops, TV box, other HDMI devices.

8 SIDE USB INTERFACE

9 BOTTOM USB INTERFACE

10 POWER INTERFACE

Just plug the power cord into the interface.

DETAILED DESCRIPTION

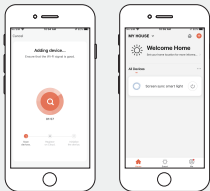

STEP 1

1. Download the "Smartlife" APP and log in to your account.
2. Click "+" in the upper right corner, then click "Lighting" in the list on the left, click "WIFI", and follow the interface prompts to add light strips.

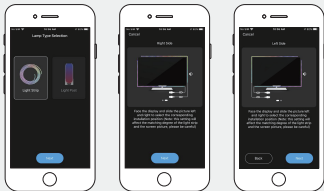

STEP 2

Click "light strip" to enter the setting interface. Select the corresponding mode according to the surrounding direction of the pasted light strip. (the interface can slide left and right)



STEP 3

After the selection is complete, click "DONE" to complete the setting.

Note: If the color is not correct, you can try to unplug the backlight box and then plug it in again.



MODE SWITCH

Click on "Video" in the menu to select and set in the "Picture" and "Music" options.

Click on "Taste" in the menu to select the appropriate scene mode.



SUPPLEMENT

If you want to reset the direction of the light strip, you can click "Setting" in the menu, select the paired light strip, and click to enter the setting.

NOTICE

- ⦿ The sync box can support up to 4K/60P sources. If you need to use it to display higher-level sources, you can use a Selector Switch Boxes to convert it.
- ⦿ You can reset to restore to the factory setting to start again if there is any problem or failure in connection.

EC

REP

LED-Trading Tobias Ebert

Schoeneicher Str. 42, Schoeneiche b. Berlin, Germany, 15566

0049 30 641 689 17 info@led-trading.de



1. Please check whether the input voltage of the constant voltage power supply is in accordance with the sync box, and please check the connection of both the cathode and anode.
2. The working Voltage is DC12V, the sync box will be broken if the voltage is higher than 12V.
3. Non-professional user cannot dismantle the Lamps directly, otherwise, it may cause fire and electric shock.
4. The working temperature is $-20\sim 60^{\circ}\text{C}$; Do not use the device to direct sunlight, moist and other high temperature area.
5. Please do not use sync box around the mental area and high magnetic field, otherwise, it will badly affect the Use effect.

DISCLAIMERS

- * This manual may contain inaccuracies or discrepancies of the product operations, or typographical errors. Our company will update the contents of this manual according to the improvements and changes of product functions, and regularly improve and update the software and hardware of products described in this manual. The updates will be shown in the latest edition of this manual without further notice.
- * Due to the continuous adoption of new technologies by our company, the product parameters will be changed without any notice in prior.
- * This manual is only for reference and guidance for customers. It does not guarantee that it is completely consistent with the actual product. The actual application is subject to the actual product.
- * The parts, components and accessories mentioned in this manual do not represent the standard configuration of the product. The detailed configuration is subject to the packing list.
- * All texts, tables and pictures in this manual are protected by the relevant national laws, and may not be used without permission by supplier.
- * The copyright and right of the final interpretation of this manual are reserved by our company.



GLEDOPTO CO., LTD

Tel: 0755-23704292

E-mail: Sales@gledopto.com

Official Website: www.gledopto.com/www.gledopto.cn

Address: 301, Building 1, Xinwuxia Industrial Area, Cuibao
Road 32, Baolong, Longgang District, Shenzhen

